

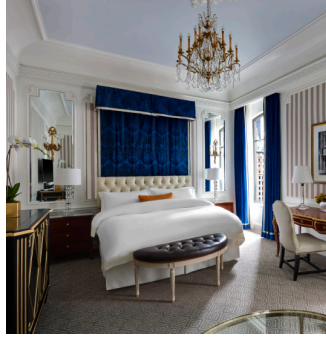

# ST REGIS

NEW YORK



## LOCATION

The St. Regis New York is desirably located at the corner of 5th Avenue and 55th Street in the heart of Midtown Manhattan, and just steps from world renowned Fifth Avenue shopping and Central Park.

John F. Kennedy International Airport (JFK), 17.5 miles ♦ La Guardia Airport (LGA), 7.5 miles ♦ Newark Liberty International Airport (EWR), 16.2 miles ♦ Teterboro Airport, 14.8 miles ♦ Penn Station (Amtrak), 2.0 miles ♦ Grand Central Station, 0.8 miles ♦ Port Authority Bus Terminal, 1.4 miles.

## DESCRIPTION

Born of a distinctive legacy, The St. Regis New York was conceived by Colonel John Jacob Astor IV more than a century ago and the timeless glamour of Astor's vision still defines this cherished landmark today. A hotel crafted for modern connoisseurs desiring the finest experiences imaginable, The St. Regis New York has defined bespoke luxury from 1904 to the present. The entire hotel was recently renovated by HDC Interior Architecture + Design, embracing the design legacy of the hotel while infusing contemporary style into this iconic Fifth Avenue address.

## SERVICES

St. Regis Butler Service ♦ Les Clefs d'Or Concierge Team ♦ 24-hour in-room dining ♦ Restaurant and bar ♦ 24-hour fitness facility ♦ 16,000 square feet of meeting space ♦ Signature turndown service ♦ Dry cleaning ♦ Complete business services, including translation and secretarial services ♦ Valet parking and limousine service (ADDITIONAL FEES MAY APPLY).

## IN-ROOM FEATURES

HD television ♦ 300 Thread Count Bed Linens ♦ Bose® radio ♦ iPod® docking station ♦ High-speed wireless Internet access ♦ Italian marble bathrooms ♦ Secure safe (ADDITIONAL FEES MAY APPLY).

## MEETING & BANQUET SPACE

Since its debut over 100 years ago, The St. Regis New York has served as the backdrop for some of the city's most important social celebrations and events. Over 16,000 square feet of newly renovated meeting space is available, including the 20th floor ballroom with incomparable views of Midtown Manhattan and Central Park.

## ACCOMMODATIONS

The St. Regis New York features 171 luxurious guestrooms and 67 exquisite suites, ranging in size from 430 to 3,430 square feet. Rooms have a fresh and sophisticated approach to modern elegance, marrying original design elements, such as the crystal Waterford chandeliers and elegant crown moldings, with beautiful, large-format photographic artwork, vibrant-hued fabrics and stunning beveled mirrors.

## HIGHLIGHTS OF NEW YORK CITY

New York City has a rich history of opening its arms to welcome visitors from around the world, offering the rare opportunity to experience world-class museums, fine dining and unforgettable performances. Visitors are invited to scale the Empire State Building, take a paddle boat ride in Central Park, soak in the bright lights of Times Square, enjoy the spectacular performances of Broadway, gaze at the works hanging in the Metropolitan Museum of Art & The Museum of Modern Art and embark for an up-close view of The Statue of Liberty.



# THE ST. REGIS NEW YORK

## MEETING & BANQUET SPACE

The St. Regis New York has served as the backdrop of the city's most important corporate events and social celebrations for more than a century. The hotel features 16,000 square feet of gathering space, accommodating events for 10-350 guests in its sixteen venues. The impeccable dedication of the highly trained event staff is matched only by the unparalleled creativity of our renowned culinary team, making The St. Regis New York the first choice of the world's most discerning hosts.

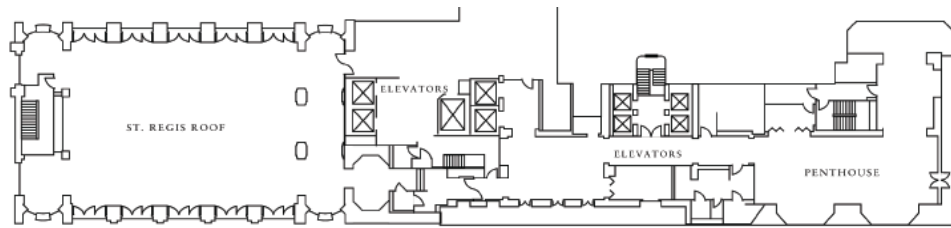

THE ST. REGIS ROOF - TWENTIETH FLOOR BALLROOM

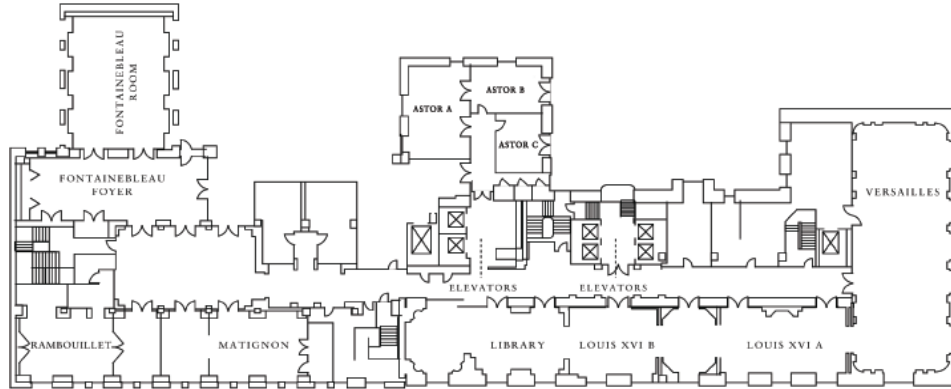

BANQUET AND MEETING FACILITIES - SECOND FLOOR

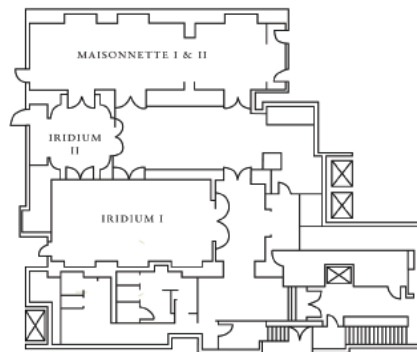

MAISONNETTE AND IRIDIUM ROOMS

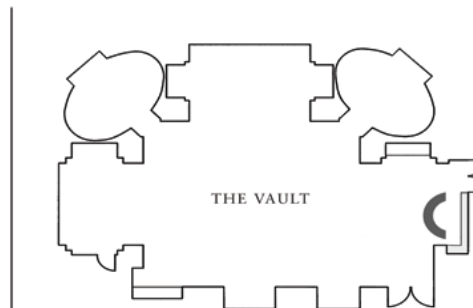

THE VAULT

	DIMENSIONS	TOTAL SQ FT	CEILING HEIGHT	BANQUET	THEATER STYLE	CONFERENCE STYLE	RECEPTION	CLASS	U-SHAPE	HOLLOW SQUARE	DINNER DANCE
ST. REGIS ROOF	85' X 51'	4,300	16'	350	300	-	300	200	85	92	250
PENTHOUSE	115' X 17'	1,950	9'	150	150	-	220	60	-	-	60
VERSAILLES	68' X 24'	1,600	15'	180	200	60	250	100	50	55	100
LOUIS XVI-A	40' X 18'	720	15'	50	50	-	125	50	-	-	-
LOUIS XVI-B	19' X 17'	325	15'	12	30	-	-	20	-	-	-
LIBRARY	43' X 15'	645	15'	40	50	25	75	30	17	22	30
ASTOR SUITES (A,B,C)	25' X 16'	920	15'	30	30	20	40	25	12	16	-
FONTAINEBLEAU	34' X 22'	750	15'	70	80	30	100	50	25	35	50
FONTAINEBLEAU FOYER	45' X 16'	720	8'4"	-	-	-	-	-	-	-	-
IRIDIUM	18' X 37'	665	10'5"	60	70	28	100	40	28	32	40
MAISONNETTE I	35' X 16'	560	10'5"	50	50	25	75	35	17	20	35
MAISONNETTE II	22' X 16'	350	10'5"	30	-	12	-	-	-	-	-
MATIGNON	24' X 15'	360	8'	-	-	14	-	-	-	-	-
RAMBOUILLET	26' X 15'	390	8'	-	-	12	-	-	-	-	-
VAULT	53' X 43'	1,100	15'	80	75	40	150	60	50	55	70